

A3

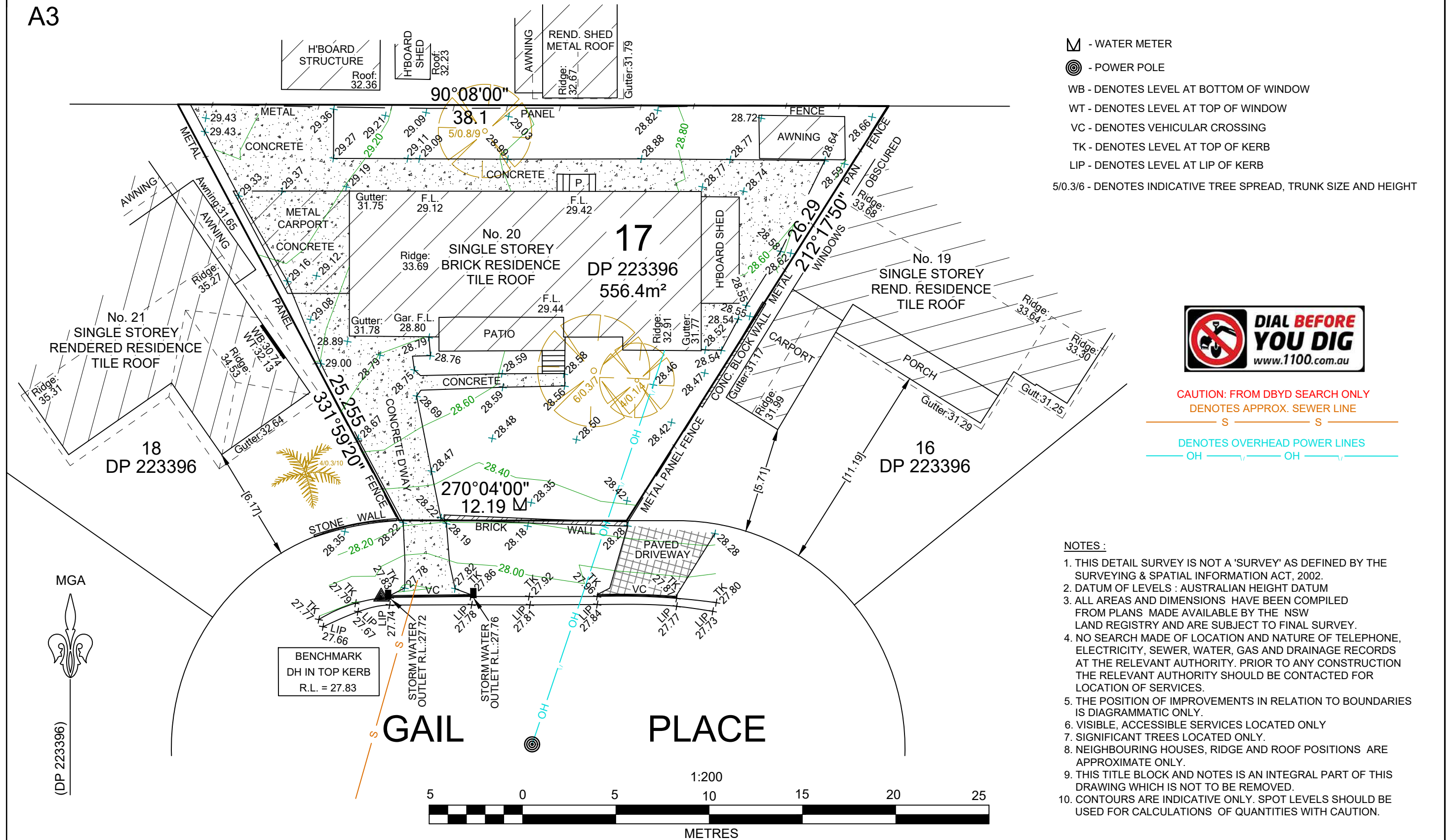

© THIS PLAN AND THE INFORMATION CONTAINED HEREIN REMAINS THE PROPERTY OF RICHARD HOGAN & CO. PTY LTD. IT MUST NOT BE COPIED IN WHOLE OR PART AND IS NOT TO BE USED FOR ANY PURPOSE OTHER THAN FOR THAT WHICH IT HAS BEEN PREPARED, WITHOUT THE WRITTEN CONSENT OF RICHARD HOGAN & CO PTY LTD. THIS PLAN HAS BEEN PREPARED FOR THE SOLE USE OF THE INSTRUCTING PARTY.

RHCO RICHARD HOGAN & CO.
SURVEYING & DEVELOPMENT CONSULTANTS

ABN 59 082 453 165
P.O. BOX 4365, Penrith Plaza, W 2750.
PHONE: (02) 4732 6599
Web: www.rhco.com.au Email: admin@hoganco.com.au

SURVEYOR: SS
DRAWN: DG
REDUCTION RATIO: 1:200
CONTOUR INTERVAL: 0.2m
SHEET 1 OF 1

ORIGIN OF LEVELS:
SSM 86624 (GNSS)
R.L. = 30.677 (SCIMS)
DATUM: AUSTRALIAN HEIGHT DATUM
DATE: 01/06/2022
VERSION No.: A

PLAN OF LEVELS AND DETAILS OVER
LOT 17 IN D.P. 223396,
No. 20 GAIL PLACE, BANKSTOWN.

CLIENT: ZAC HOMES (#222039)

L.G.A.: CANTERBURY-BANKSTOWN

JOB REF: 22310